

RED TOP PLAZA

1300-1440 S. Milwaukee Ave., Libertyville, IL 60048

For information: **Luke Sementa**

E: lsementa@sterlingorganization.com

P: 855-505-7239

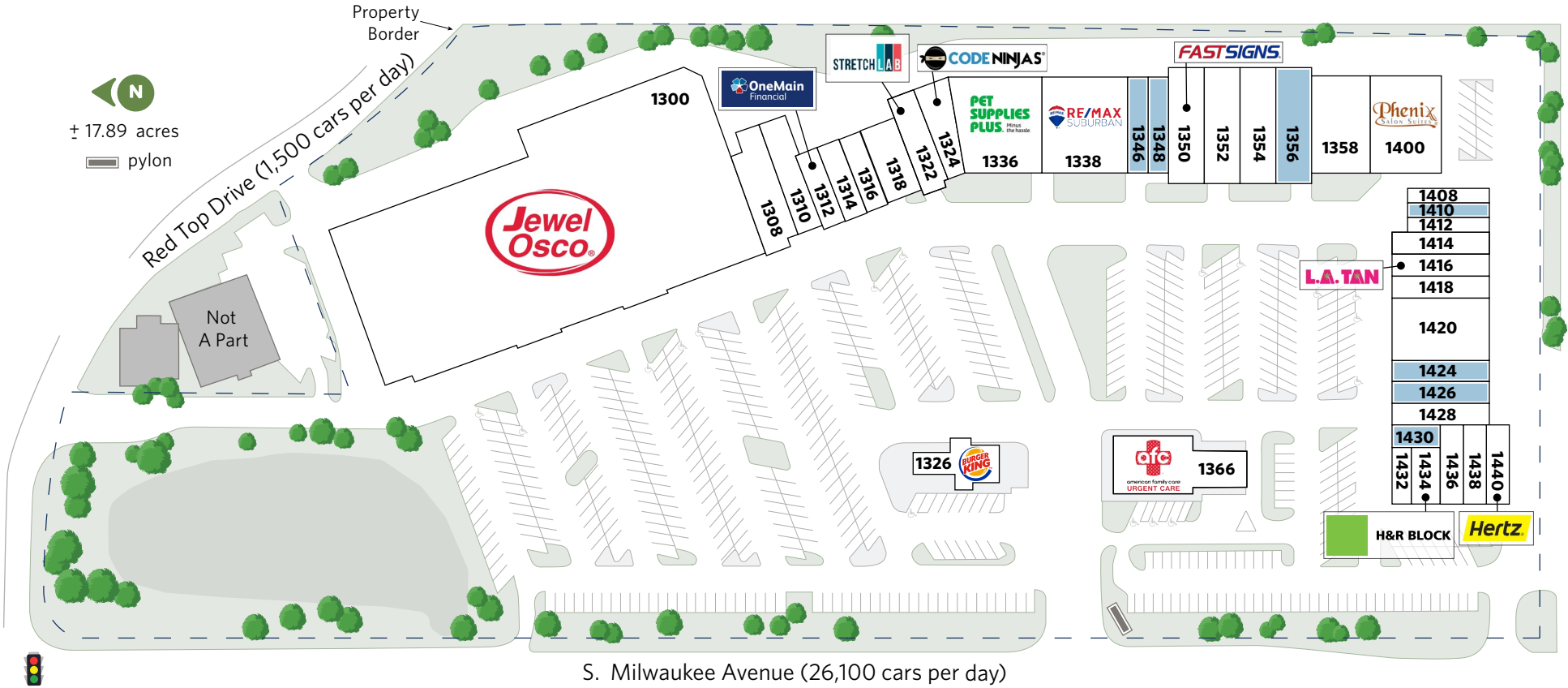

UNIT	TENANT	SQ. FT.
1300	Jewel-Osco	66,844
1308	Vision Care	2,760
1310	Massage Motu & Chiropractic	3,000
1312	OneMain Financial	1,200
1314	Warhammer	1,200
1316	Asurion Tech Repair & Solutions	1,200
1318	Hunan Palace	2,400
1322	StretchLab	1,600
1324	Code Ninjas	2,736
1336	Pet Supplies Plus	6,400

UNIT	TENANT	SQ. FT.
1338	RE/MAX Suburban	6,400
1346	Available	1,600
1348	Available	1,600
1350	Fast Signs	2,500
1352	Athletico Physical Therapy	2,500
1354	Ki Martial Arts	2,500
1356	Available	2,500
1358	Foss Swim School	5,205
1400	Phenix Salon Suites	7,595
1408	Nails First	1,200

UNIT	TENANT	SQ. FT.
1410	Available	1,200
1412	Mandu	1,200
1414	Studio Elevate Fit	1,600
1416	L.A. Tan	1,600
1418	Great Lakes Dental	1,600
1420	Plato's Closet	3,200
1424	Available	1,600
1426	Available	1,600
1428	La Mera Mera Taqueria	1,600
1430	Available	800

UNIT	TENANT	SQ. FT.
1432	Tide Dry Cleaners	800
1434	H&R Block	1,200
1436	Lou Malnati's Pizzeria	1,300
1438	Max's Dawg House	1,300
1440	Hertz	1,300
1326	Burger King	3,000
1366	AFC Urgent Care (Coming Soon)	4,000

Total Square Feet: 151,840